



Lecture (02) Extended Service set with DHCP server Multilayer Switch I

By:
Dr. Ahmed ElShafee

Dr. Ahmed ElShafee, ACU : Semester Year, Practical App Network II

Topology 01 - 4 DHCP servers

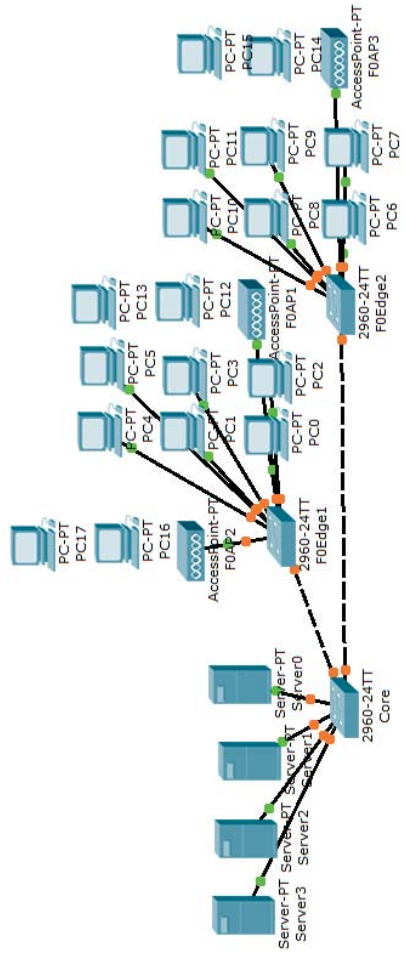

Y

Dr. Ahmed ElShafee, ACU : Semester Year, Practical App Network II

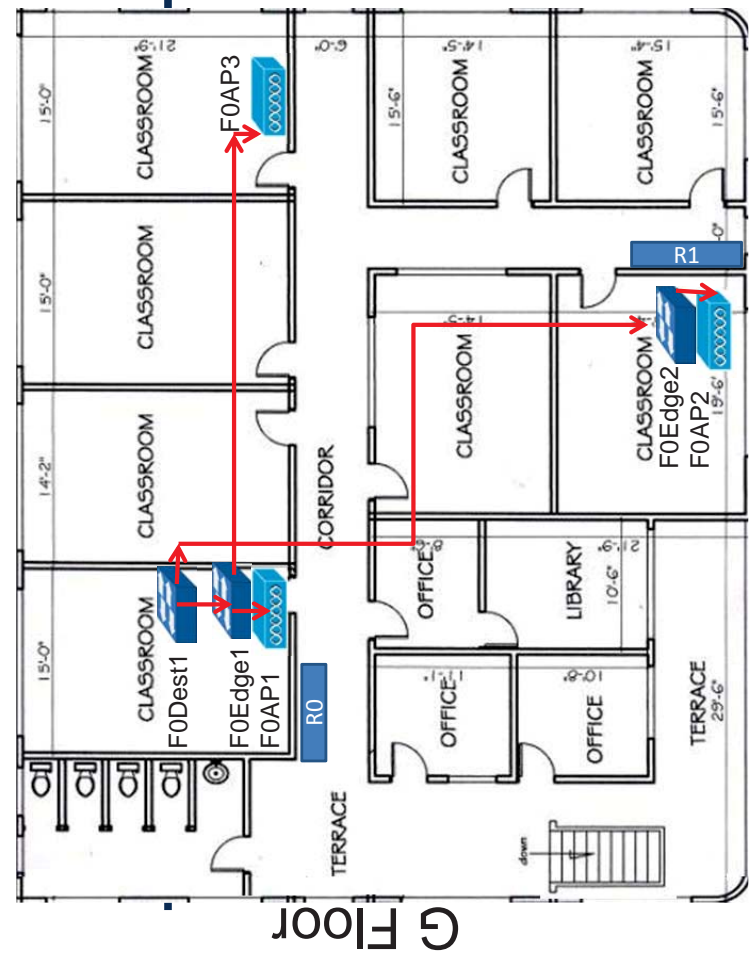

F0Dest

```
enable
config t
hostname Core
line vty 0 4
password cisco
login
line console 0
password cisco
login
enable password cisco
enable secret cisco1
interface vlan 1
ip address 10.0.10.1 255.255.255.0
no shutdown
vtp domain ACU
vtp mode server
```

```
vlan 2
name vlan2
vlan 3
name vlan3
vlan 4
name vlan4
vlan 5
name wlan
interface range fa0/1-24
speed auto
duplex auto
interface range fa6/1-24
switchport mode trunk
interface fa0/2
switchport mode access
switchport access vlan 2
```

Y

Dr. Ahmed ElShafee, ACU : Semester Year, Practical App Network II

```

interface fa0/3
switchport mode access
switchport access vlan 3

interface fa0/4
switchport mode access
switchport access vlan 4

interface fa0/5
switchport mode access
switchport access vlan 5

spanning-tree vlan 1,2,3,4,5 root primary

end

```

Dr. Ahmed ElShafee, ACU : Semester Year, Practical App Network II

DHCP Server@VLAN02

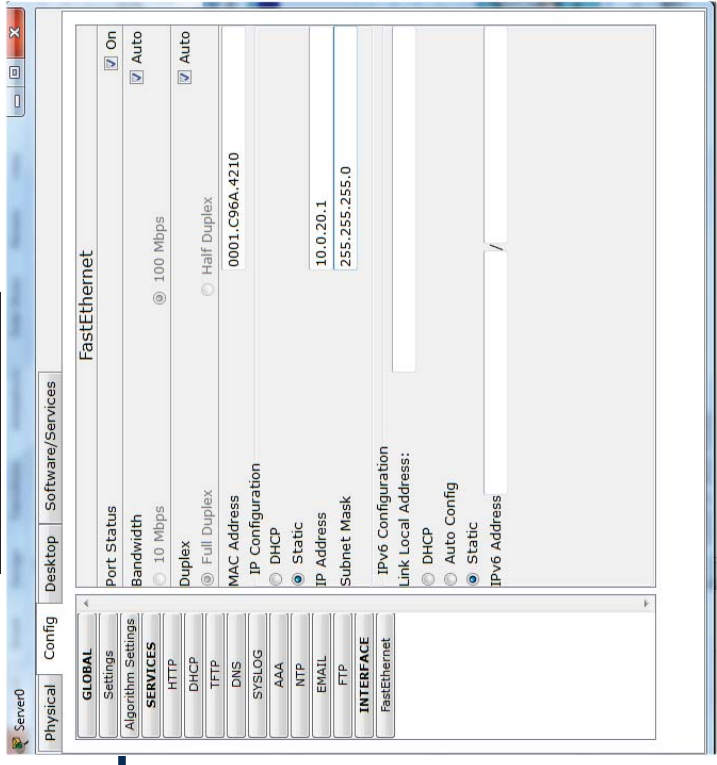

PC@VLAN02

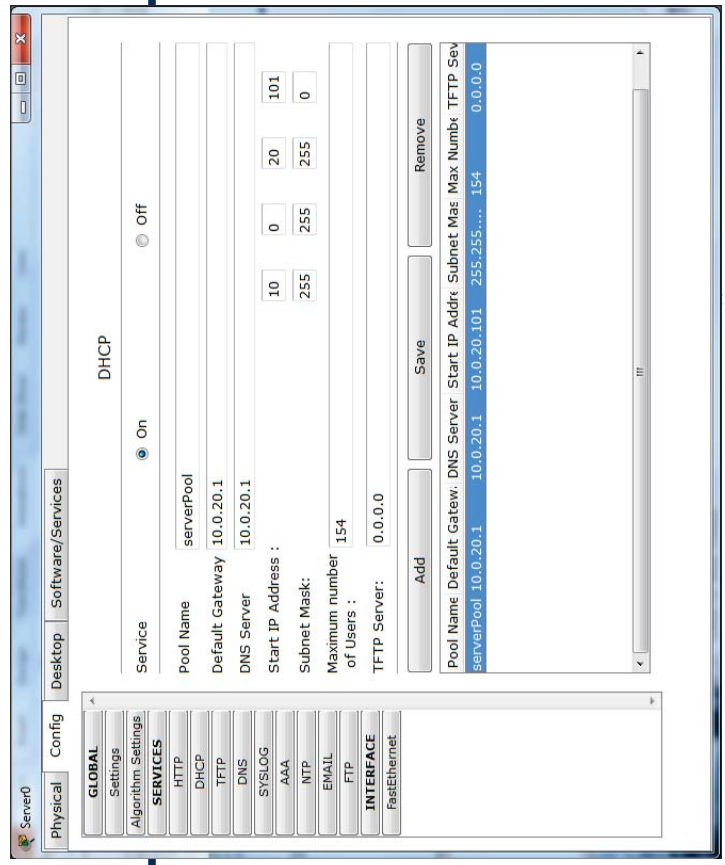
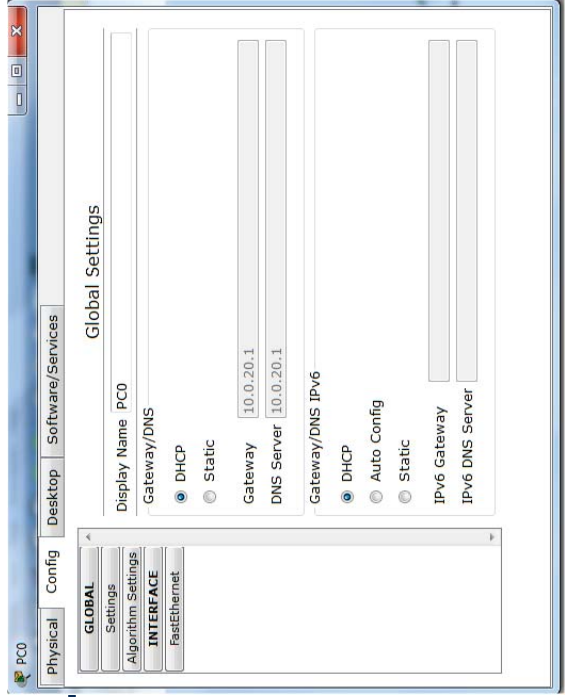

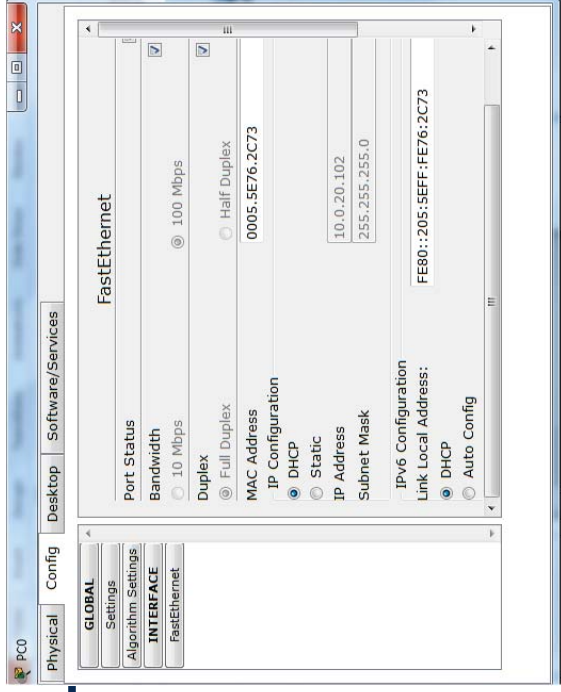

Dr. Ahmed ElShafee, ACU : Semester Year, Practical App Network II

Dr. Ahmed ElShafee, ACU : Semester Year, Practical App Network II

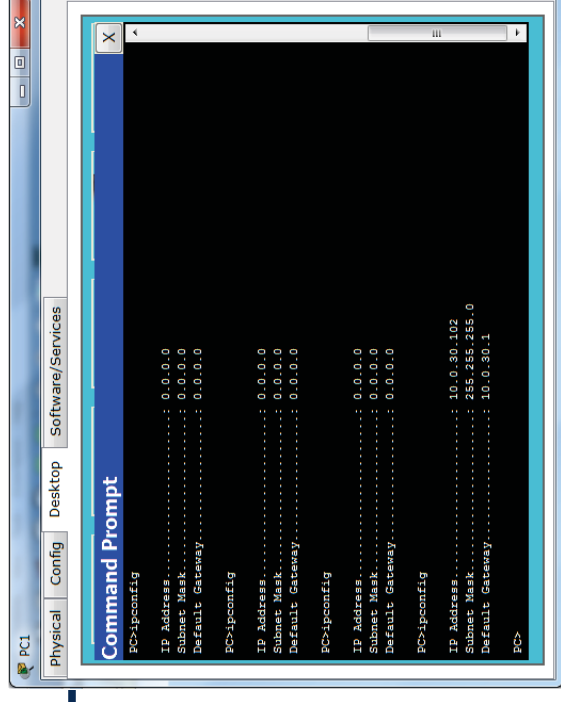

Testing

- all switches can access all other switches
- F0/24 is the core
- All PCs on VLAN 02 can access each other
- All PCs on VLAN 03 can access each other
- All PCs on VLAN 04 can access each other
- All Wireless PCs can access each other

11

Dr. Ahmed ElShafee, ACU : Semester Year, Practical App Network II

Multilayer Switch 3560



11

Dr. Ahmed ElShafee, ACU : Semester Year, Practical App Network II

What is the difference between L2 & L3 switch

1. Can exchange IP packets between different VLANs if the switch can identify the destination
2. While passing packets through trunk port, switch strip L2 header/tale of packet including VLAN tag (802.1q protocol), determine destination port, add new L2 header/tale to IP packet contains VLAN tag for destination port.

١٢

IEEE 802.1Q Frame-Tagging Standard

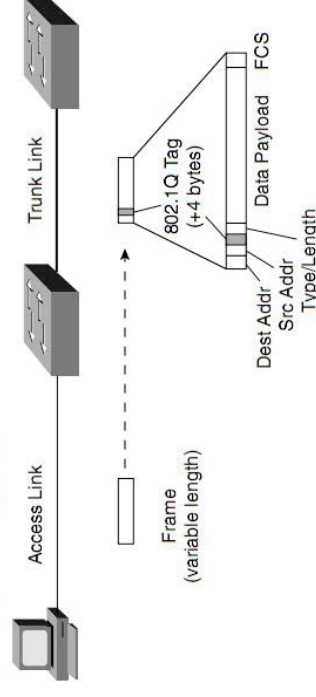

١٤

Topology 1, with Multilayer Switch

Commands can be only executed on multi-layer switch

- Enable L3 packet routing
 - ip routing
- Enable encapsulation on trunk ports
 - interface range fa0/1-24
 - switchport trunk encapsulation dot1q
 - switchport mode trunk

١٥

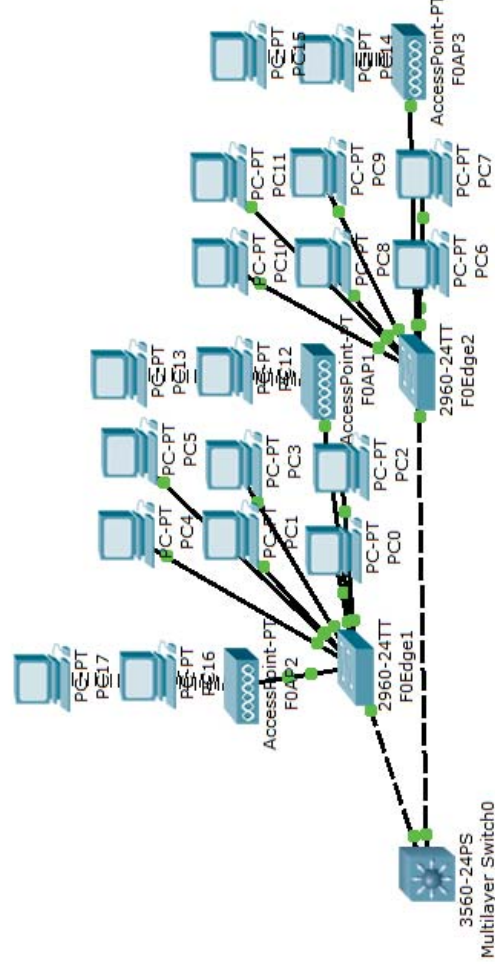

١٧



Thanks,..
See you next week (ISA),...